

- Standard Description -

40E



DUFOUR | 40E
Performance

DUFOUR
YACHTS

The Ultimate Sailing Pleasure

40E

DUFOR | 40E
Performance

>>> TECHNICAL SPECIFICATIONS

>>>

Architects :Umberto Felci / Patrick Roséo

Overall length :12,35 m
 Hull length :11,99 m
 Waterline length :10,76 m
 Max beam :3,89 m
 Displacement empty with standard keel :7 386 Kg
 Displacement empty with deep keel :7815 Kg
 Draft standard keel :2,10 m
 Draft deep keel :1,75 m
 Standard keel weight :2 386 Kg
 Deep keel weight :2 815 Kg
 Air draft with standard mast :17,86 m
 Diesel capacity :200 L
 Water capacity :360 L
 Engine power :40/55 CV

>>> SAILS >>>

Sail surface close hauled :91 m²
 Mainsail :48 m²
 Genoa :43 m²

>>> SAIL PLAN >>>

I :14,65 m
 J :4,20 m
 P :14,35 m
 E :5,46 m
 LP (140 % overlap)5,88 m

>>> CONSTRUCTION >>>

- Hand laminated GRP Hull, vacuum bagged PVC foam coresandwich above water line.
- NPG Gelcoat with first of cloth impregnated with NPG resin forming an optimum barrier against osmosis.
- Inner moulded hull bottom, structural framing laminated to the hull.
- Navy blue decorative stripes on the hull.
- Diamond point non skid profile on deck.
- Roof covered with Iroko FSC wood. As an optional: side decks and cockpit covered in Iroko FSC.
- Deck in PVC foam core sandwich, moulded by injection process (Resin Transfer Moulding) for significant weight saving, excellent interior finish, and a perfect rigidity.
- Standard draft 2.10 m, cast iron keel, bolts loads taken up by stainless steel backing plate.
- Semi-elliptical rudder, filled with closed cell epoxy foam. Rudder stock in plain stainless steel.
- Steering wheel system on self aligning roller bearings and ball bearings sheaves for a maximum of sensation and steering precision.



>>> DECK & RIGGING >>>

- Wood handrails on coachroof.
- Wood toerail on hull-deck joint.
- Self-draining chain locker with eye bolt and integrated windlass bracket, cover with locking bolt.
- Removable stemhead fitting with removable anchor roller.
- Pulpit in two separate parts with separate green/red navigation lights.
- Asymmetrical spinnaker tack ring ahead of forestay.

- Pushpits with horseshoe buoy bracket, flag pole holder and opening cable gate with hook.
- Stanchions with 2 levels of stainless steel guard-rails and life lines gates.
- 4 mooring cleats on backing plates, stainless steel rubbing plates on sheer line.
- Single chainplate for cap shrouds/aft lower shrouds including an eye for fixing extra control lines.
- 2 deck filler plates for water, 1 for fuel.
- Mainsheet track on cockpit sole with adjustable traveller.
- Genoa sheet tracks with piston lead blocks.
- 2 genoa sheet return blocks with integrated jammer and eye for flying spinnaker sheet sheave.
- Aluminium mast collar with synthetic protection and sheet return blocks.
- Mast step in aluminium with halyard return blocks.
- Stainless steel swan neck electric cable gland.
- 2 deck organizers for halyard returns.
- 7 spinlocks on coachroof.
- 2 halyard winches on coachroof.
- 2 Genoa furling lines at hand of the helmsman.
- Deck block with jammer for genoa roller furling system.
- Sliding hatch and washboard in plexiglas, with stoppers and lock.
- GRP cover ahead of companionway.
- Deck panels integrated in the roof.

>>> COCKPIT >>>

- Iroko FSC trimmed seats, GRP sole.
- Central removable footrest.
- 2 large side lockers with lids fitted with padlock hasps.
- Twin steering wheel system. Wheels in stainless steel. Engine control lever on starboard side.
- Large Propane locker on portside.
- Spacious cockpit locker integrated in the sole of the cockpit.
- 2 compasses for cruising and regatta purposes.
- Navigation instruments placed on cockpit bulkhead.
- Life raft stowage in dedicated locker under sole.
- Tilting aft platform with integrated bathing ladder.

- Shore power socket in cockpit.
- Cockpit shower hot/cold.

>>> MAST AND RIGGING >>>

* long mast

- Anodised aluminium mast with double swept backed spreaders, rigged 9/10. Mast is stepped on the keel.
- Profiled Performance mast.
- Anchor and steaming lights.
- Removable inner forestay available as an optional.
- Boom topping lift cleat.
- Anodised aluminium boom equipped with single line reefing system (2 reefs)*.
- Rigid boom vang, with tackle led back to cockpit.
- Genoa furling system with drum below deck.
- Discontinuous standing rigging in single strand stainlesssteel cable and Dyform*, chrome plated bronze turnbuckles including: forestay, backstay, cap shrouds, inter and lower shrouds.
- Backstay adjusted with stay tensioner.
- Running rigging in pre-stretched textile including: main and genoa halyards, boom topping lift, main and genoa halyards, boom topping lift, main and genoa sheets, reef lines and furling line.
- Mainsail with Dufour logo, in high tenacity cloth and 2 reefing lines. Mainsail cover in light grey Dufour colours.
- Furling genoa with UV-protection.

>>> INTERIOR >>>

- All joinery work in prime choice light Moabi mahogany, with fiddles and mouldings in solid wood.
- Cabin doors with double anti-vibration bolts.
- Floorboards in Moabi, high quality marine plywood.
- The floor boards are in laminated marine Moabi wood.
- Cabin mattress covers are quilted and made of anallergic fabric.
- Saloon cushions have removable covers in cream colour suede (other colours available as an option).
- Ceiling lining of both cabins and saloon in white coloured marine wood.

3 cabin version, 1 head

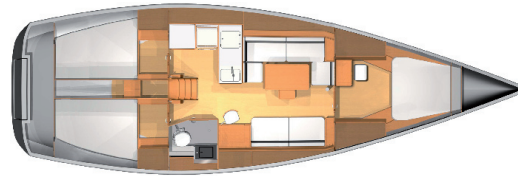

3 cabin version, 2 head (option)

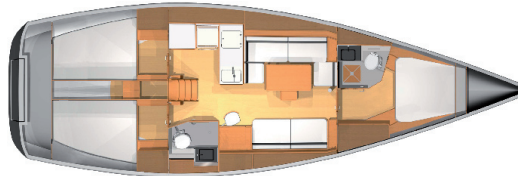

2 cabin, 1 head (option)



>>> VENTILATION & LIGHTING >>>

- Ventilation through 7 deck hatches and 4 opening portlights.
- Roller blinds for all deck hatches with integrated mosquito screens.
- Extra light through 2 fixed roof and 6 fixed hull portlights.
- Ambient night lighting at saloon floor level.

>>> COMPANIONWAY >>>

- Headroom: 1.93 m.
- Removable companionway equipped with gas springs for easy access to the engine compartment.
- Dedicated stowage for companionway door inside the boat.
- Stowage under floor boards.
- 2 hand rails.

>>> FORWARD OWNER'S CABIN >>>

- Headroom: 1.89 m.
- Large berth approx. 200 x 140 cm.
- 10 cm mattress in 2 parts with washable covers.
- Access to stowage lockers under berth.
- Upper lockers with fiddle on hull side around berth to create a maximum of storage space.
- Large hanging locker with shelves
- Vanity table with storage on port side including removable seat that also be used at the saloon table of the 3 cabin/1 head version and 2 cabin/1 head version.
- Shoe locker.
- Book shelf.
- Big drawer under the berth.
- Water tank under the berth.
- Light and ventilation guaranteed by a big size deck hatch, 2 portlights (according to version), 1 cabin and 2 reading lights.
- Access to navigation instrument transducers.

>>> HEAD(S) >>>

- Manual marine toilets with cover in teak.
- Wash basin in synthetic «Corian®» stone, with an excellent finish and ideal for easy maintenance.
- Large mirror.
- Chrome plated brass mixer tap with shower unit.
- Shower with direct drainage by electric pump.
- Floor grating in teak in the front heads (in 3 cabin/2 heads version).
- Closing upper lockers with space for holding tanks.
- Ventilation by deck panel or opening portlight.
- Hooks in aft head for hanging oilskins.

>>> SALOON >>>

- Large U-shaped settee on portside with storage facilities.
- Settee on starboard side with storage facilities. Backrests and seats in foam. Suede cream colour covers, removable for ease of maintenance.
- Rectangular table with fiddles in wood.
- Saloon table with 2 folding blades to facilitate circulation and (as an option) with integrated bar.

- Stowage under seats and behind backrests. 2 stowage lockers with doors and a bookshelf above each settee.
- Bar and storage integrated in the arm rests.
- Light and ventilation by 2 deck hatches, 2 fixed portlights, 2 opening hatches, and 6 ceiling lights for optimum ventilation and day light inside.
- Ambient ceiling lights.

>>> GALLEY >>>

- L-shaped galley close to companionway.
- Working top in white Corian® surrounded by wooden fiddles.
- Double stainless steel sink. Chrome plated brass mixer tap for pressurised water (cold/hot).
- Cooker with 2 burner stove/oven on gimbals.
- Big volume refrigerator (180L) 12V with lateral and top access.
- Stowage under sink with shelf and trays. Garbage bin, with double compartments, nicely hidden behind a hinged door.
- Sea water foot pump integrated in the floor.
- Outboard lower cabinet with cutlery drawer and sliding vegetable baskets. 3 upper cabinets with doors on hull side, one of which can house a microwave oven (option).
- Crockery set with fiddle system for protection when yacht is heeling.
- 2 big size lockers for a maximum of stowing space.
- Light and ventilation ensured by opening port-light and 2 spotlights over galley.
- Crumb tray under sole.

>>> CHART TABLE >>>

- Large format chart table with hinged desk top, close to companionway.
- Seat with cushion in suede (for ease of maintenance).
- Outboard panel with switchboard and instrument panel.
- Drawer.
- Book shelve.
- Light assured via ceiling spot light.

>>> AFT(S) CABIN(S) >>>

- Headroom: 1.95 m.
- Double berth approx. 200 x 134 cm.
- 10 cm thick foam mattress with washable cover.
- Big size hanging locker with double door and shelves.
- Shelf with sea-fiddle.
- Access to the engine and technical compartment.
- Extra stowing space for each cabin in the central compartment under the cockpit (3 cabin version).
- Engine compartment with high quality insulation.
- Water tank under port berth.
- Full length storage shelf with fiddle on hull side.
- Lighting and ventilation by a deck hatch and an opening port-light and by 1 dome light and 1 reading spotlight.
- Fuel tank under starboard berth.
- Water tank under port berth.
- Battery switches.

>>> ENGINE >>>

- VOLVO 40 hp (29 kW). Sail-drive transmission.
- Heat exchanger, anti-siphon valve. Large capacity sea water filter.
- Control panel close to helmsman, with hour meter and tachometer.
- Alternator with battery isolator.
- Fuel tank approx. 200 L, gauge on electrical switchboard.
- Fuel filter with water separator.
- Emergency fuel shut-off handle.
- Engine room ventilation blower, and 2 ventilation hoses.
- Two-blade fixed propeller.
- Access to the engine from front and both sides.
- Independent engine bilge.
- Quality sound proofing high density foam for optimum sound insulation.

>>> PLUMBING >>>

- 2 polyethylene tanks for a total capacity of approx. 360 L with inspection plates and gauges at electrical panel.
- Sump built into keel.
- 20 L water heater running off engine transfer.
- Electric bilge pump with strainer and filter and controls on switchboard.
- Manual bilge pump operated from cockpit.
- Drainage of shower water by pump direct to the sea.

>>> ELECTRICITY >>>

- 12 V DC SYSTEM. 15 function switchboard. 12V outlet at galley and switchboard.
- 1 x 100 Ah engine battery and 2 x 100 Ah service batteries.
- Battery switch for each battery in aft port cabin.

>>> MISCELLANEOUS >>>

- 2 winch handles with holder.
- Owner's briefcase with owner's manual.
- Grounded rigging system.

DUFOUR YACHTS- 1 rue Blaise Pascal
FR-17187 PERIGNY
www.dufour-yachts.com

The descriptions, illustrations, etc. given are for information only. Our models may be subject to certain production improvements or modifications without notice.

DUFOUR
YACHTS

The Ultimate Sailing Pleasure